

No doubt you strive to achieve greater efficiency? Then ECO Plus 2 bearing technology is essential for you.

The effective bearing technology of the ECO Unit has been a contributing factor in the success of more than 12 million sold BPW axles. After all, its enclosed design guarantees that the highest possible mileages and serviceability can be achieved. The ECO Unit has undergone consistent further development. Result: The newest version, ECO Plus 2. It is impressive with its numerous innovative details that make the chassis even more convenient for maintenance and repair. In addition to this, it significantly contributes to the reduction in weight of up to 25 kg over the complete ECO Plus 2 axle system.

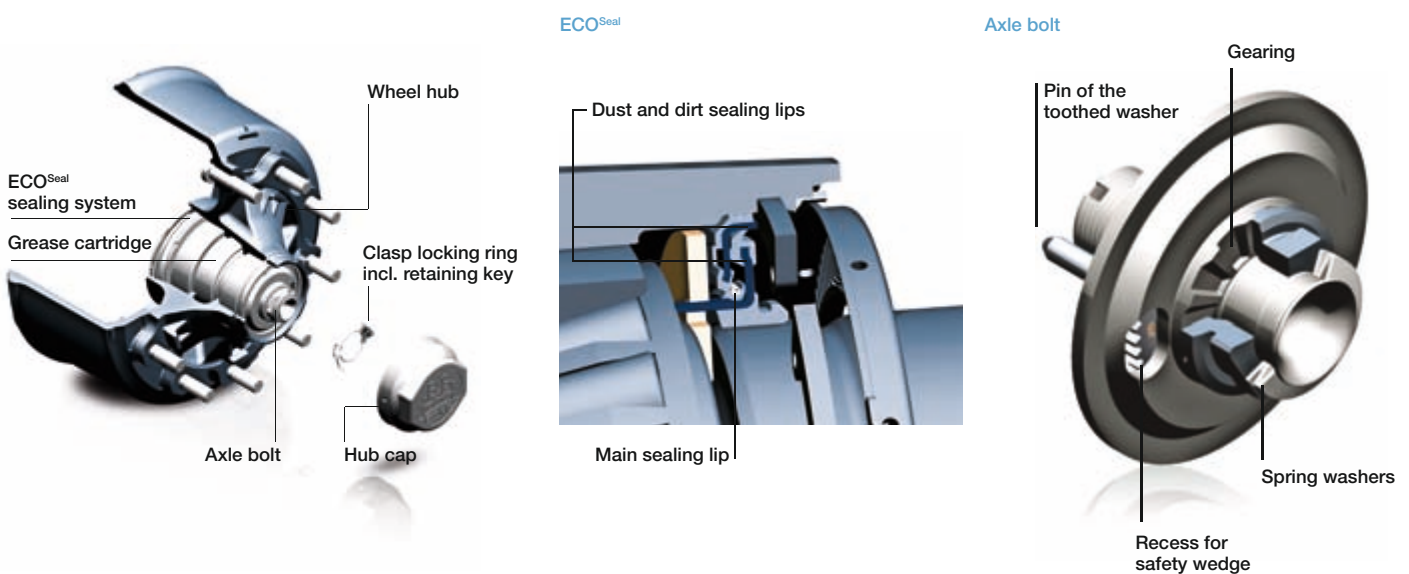

The proven ECO Unit is a master when it comes to ease of maintenance and efficiency. This is not only because of the reduced weight but also, for example, the use of globally available DIN ISO tapered roller bearings as well as rapid removal/installation using the central axle bolt, similar to Formula 1. Innovative design features such as the grease cartridge, the practical bayonet lock for the hub cap and the axle bolt with integrated torque limitation underline BPW's power of innovation.



ECO Unit – Features and benefits

- ▶ Maintenance-free, closed bearing system
- ▶ Significant weight reduction (by up to 25 kg)
- ▶ High mileage because of enclosed design of the bearing technology
- ▶ Quick to remove and install using the Formula 1 principle with the central axle bolt
- ▶ Automatically set bearing pre-load by central bolt with integrated torque limiter
- ▶ Easy to grease the bearings with the grease cartridge
- ▶ Hub cap with practical bayonet lock
- ▶ 5 + 3 years ECO Plus warranty with unlimited mileage
- ▶ Globally available DIN ISO tapered roller bearings for widespread availability and rapid service

More information:

▶ ECO Plus Warranty (page 8) ▶ BPW News Allg. 7125703e